

# CREE® XLAMP™ 7090 LED

## DATA SHEET

Data Sheet: DS-00002 Rev A

### > XLamp™ 7090 Packaged LEDs



Cree XLamp 7090 LEDs combine the brightness of power LED chips with a rugged package capable of operating in excess of one Watt. Cree XLamp LEDs lead the solid-state lighting industry in brightness while providing a reflow solderable design that is optimized for ease-of-use and thermal management. Lighting applications featuring XLamp LEDs maximize light output and increase design flexibility, while minimizing environmental impact.

Cree XLamp 7090 LEDs bring the power of brightness to a wide range of lighting and backlighting applications including portable lighting and flashlights, computer and television screens, signaling, architectural, landscaping and entertainment/advertising.

### > Benefits

Cree XLamp 7090 LEDs provide:

- Industry's brightest 1-Watt package
- Surface mount technology — reflow solderable
- Wide range of colors
  - White, Royal Blue, Blue, Cyan, Green, Amber, Red-Orange and Red
- Low operating voltage
- Full dimming
- ROHS compliant — lead-free
- Integrated lens
- Small footprint — 7.0 mm x 9.0 mm
- ESD > 2000V

## > Characteristics

Color	Dominant wavelength (nm) or CCT (K)		Typical Luminous or Radiant flux @ 350mA
	Min.	Max.	
White	4500K	8000K	45lm
Royal Blue	455nm	465nm	255mW
Blue	465nm	475nm	19lm
Cyan	500nm	510nm	30lm
Green	520nm	535nm	45lm
Amber	585nm	595nm	27lm
Red-Orange	610nm	620nm	38lm
Red	620nm	635nm	34lm

\*For details on Cree's procedures for sorting, binning and labeling and a list of standard order codes see application note: Cree XLamp 7090 LED Binning and Labeling

Characteristics	Unit	XLamp 7090
Thermal resistance, junction to solder point	°C/W	17
Maximum forward voltage @ 350mA (white, royal blue, blue, cyan, green)	V	4
Maximum forward voltage @ 350mA (amber, red-orange, red)	V	3
Viewing Angle	degrees	100
Temperature coefficient of voltage (royal blue, blue, cyan, green, white)	mV/°C	-3.0 - -2.8
Temperature coefficient of voltage (amber, red-orange, red)	mV/°C	-3.2 - -3.0
ESD Classification (HBM per Mil-Std-883D)		Class 2

	Unit	XLamp 7090
Maximum DC Forward Current	mA	350
Maximum Reverse Voltage	V	5
Maximum LED Junction Temperature	°C	125
Minimum Operating Temperature	°C	-20
Maximum Operating Temperature	°C	85

> Relative Spectral Power

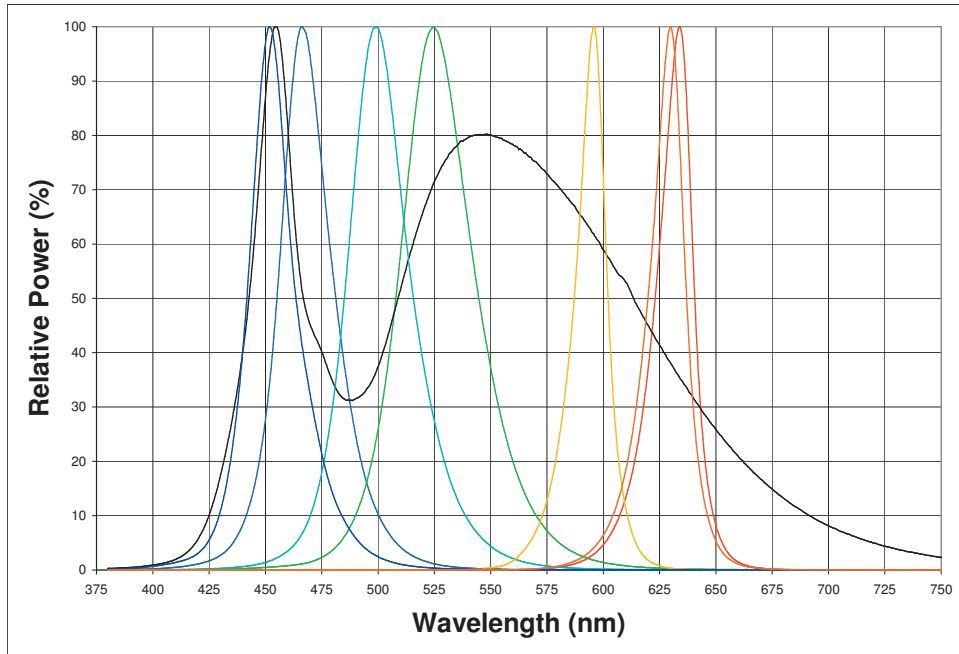

## > Electrical Characteristics ( $T_A = 25^\circ\text{C}$ )

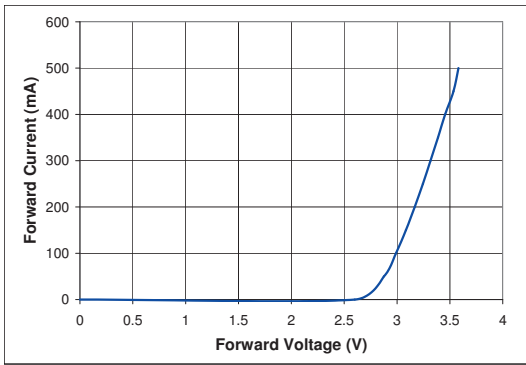

Royal Blue, Blue, Cyan, Green, White

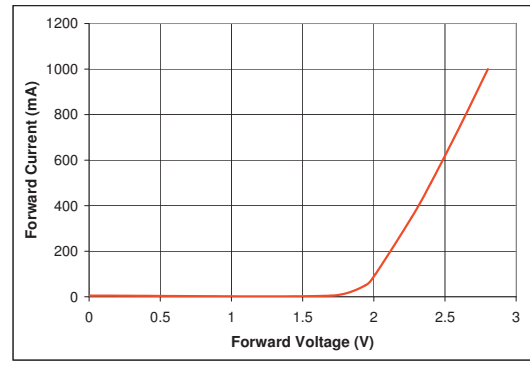

Amber, Red-Orange, Red

## > Thermal Design

The maximum forward current is determined by the thermal resistance between the LED junction and ambient. Given an existing thermal resistance of  $17^\circ\text{C/W}$  between the junction and the solder point, it is crucial for the end product to be designed in a manner that minimizes the thermal resistance from the solder point to ambient in order to optimize lamp life and optical characteristics.

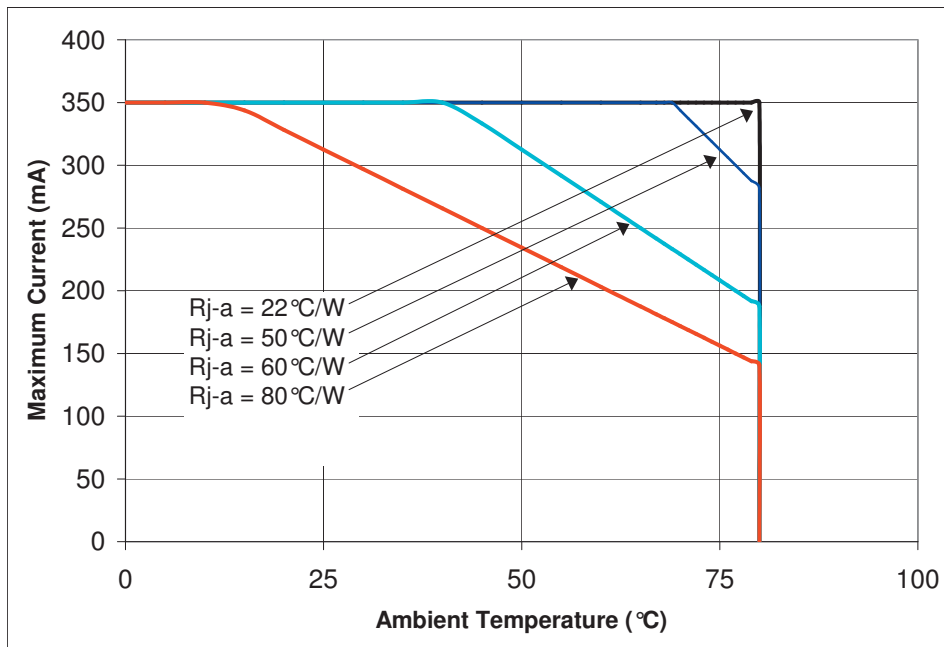

> Relative Intensity vs. Current,  $T_A = 25^\circ\text{C}$

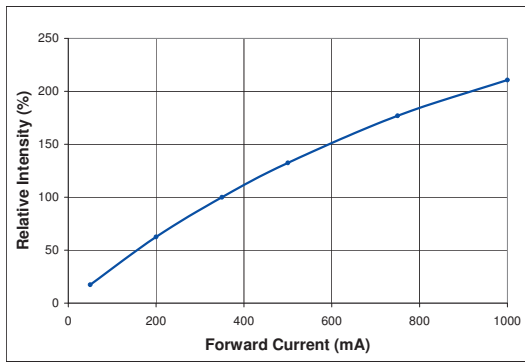

Royal Blue, Blue, Cyan, Green, White

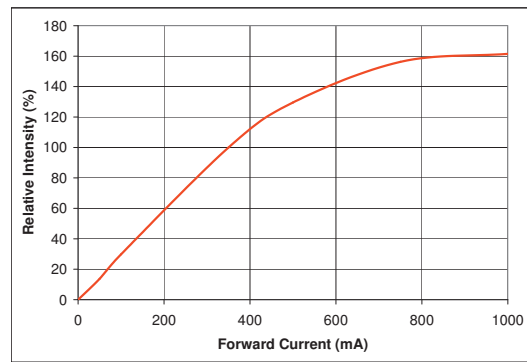

Amber, Red-Orange, Red

> Relative Intensity vs. Junction Temperature,  $I_f = 350\text{mA}$

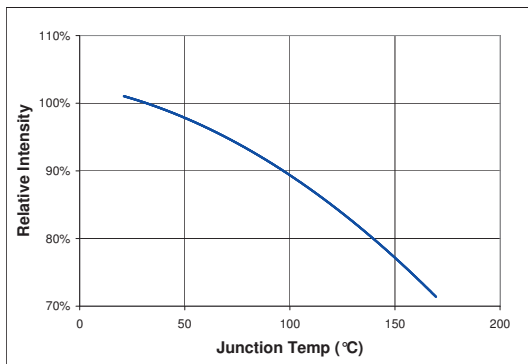

Royal Blue, Blue, Cyan, Green, White

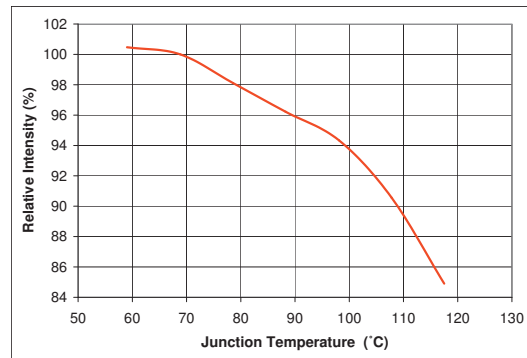

Amber, Red-Orange, Red

## > Mechanical Dimensions

All measurements are  $\pm 0.1\text{mm}$  unless otherwise indicated.

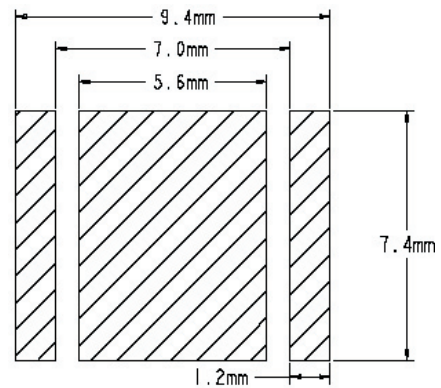
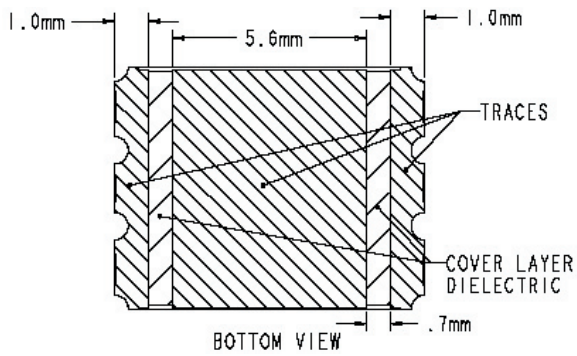
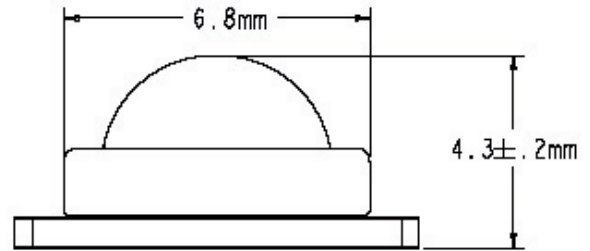
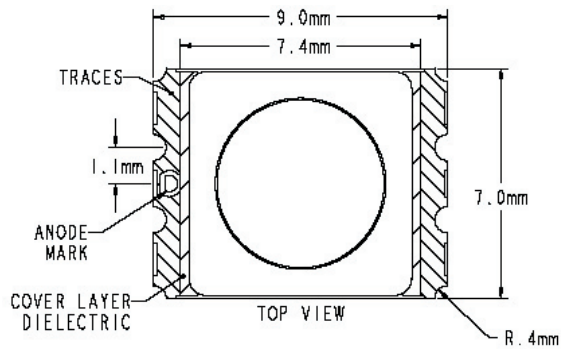
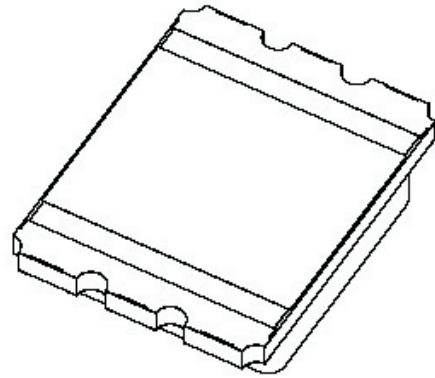
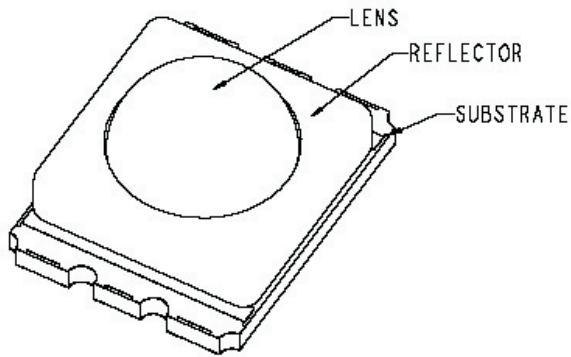

> Tape and Reel

All dimensions in mm.

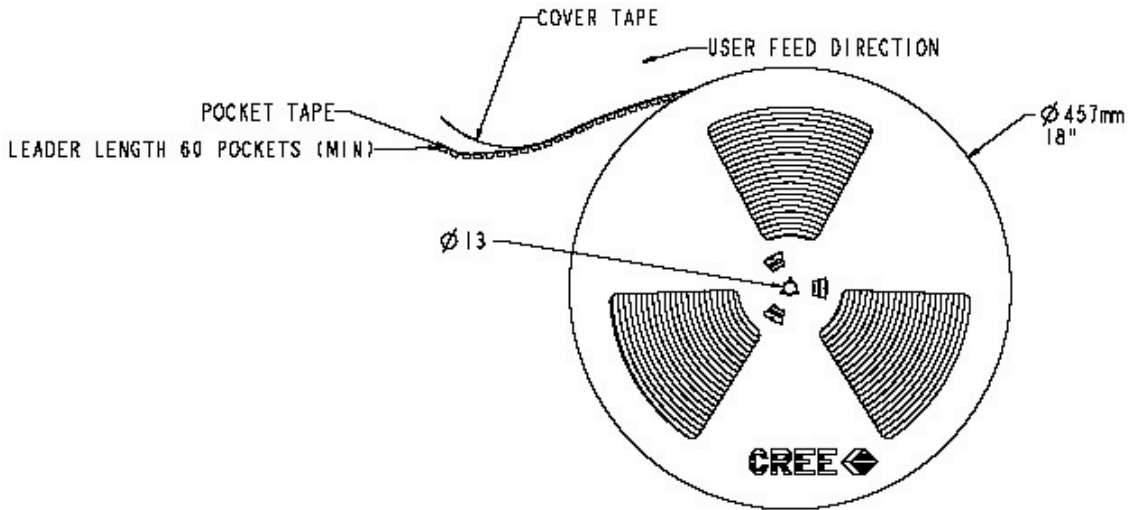
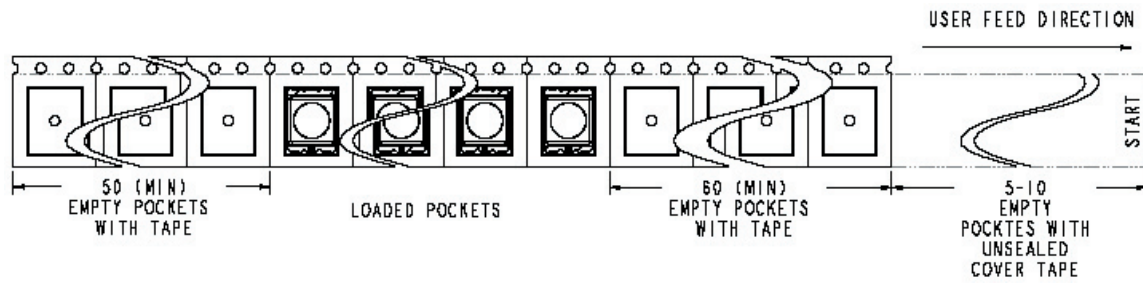
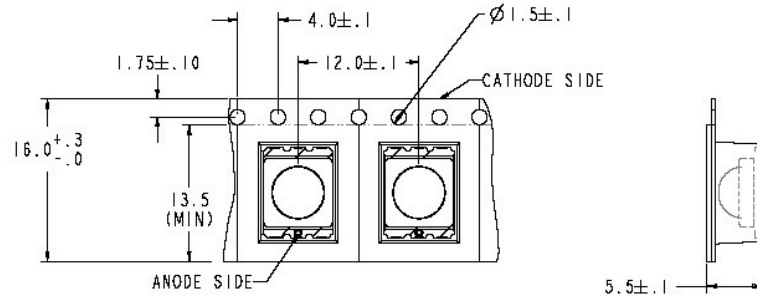

> Dry Packing and Packaging

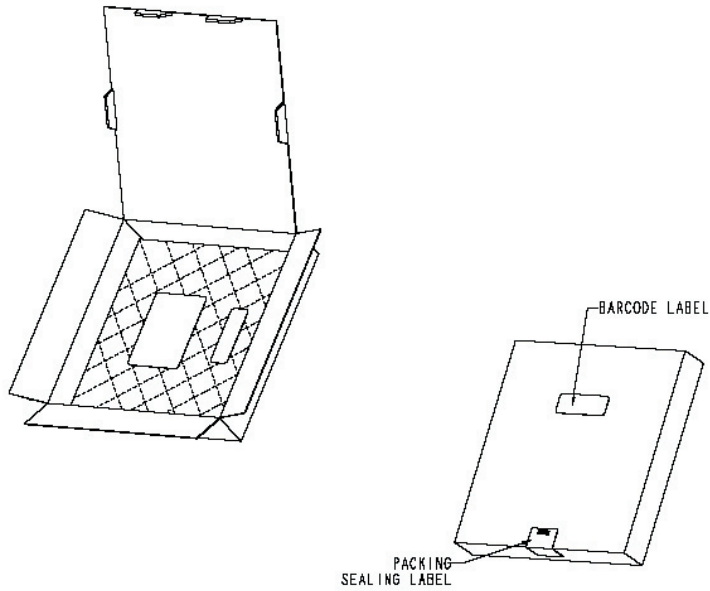
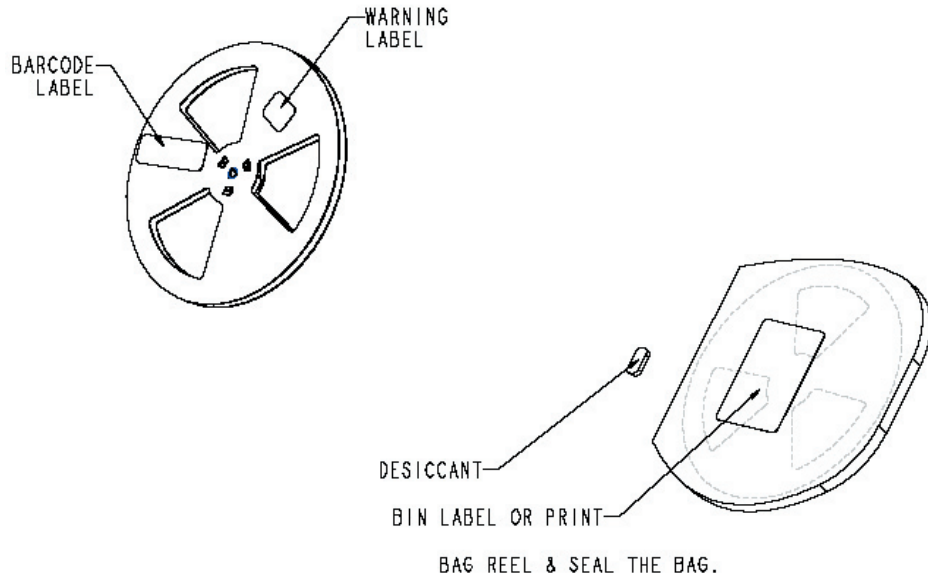

Copyright © 2004 - 2005 Cree, Inc. All rights reserved. Permission is given to reproduce this document provided the entire document (including this copyright notice) is duplicated. The information in this document is subject to change without notice. Cree, the Cree logo and Cree Lighting are registered trademarks, XLamp and LED Light by Cree are trademarks of Cree, Inc.

LED Light by Cree™  
4600 Silicon Drive · Durham, NC 27703 · USA  
Tel: +1.919.313.5300 · Fax: +1.919.313.5778  
[www.cree.com/xlamp](http://www.cree.com/xlamp)



Page 9  
Subject to change without notice.  
<http://www.cree.com/xlamp>

